

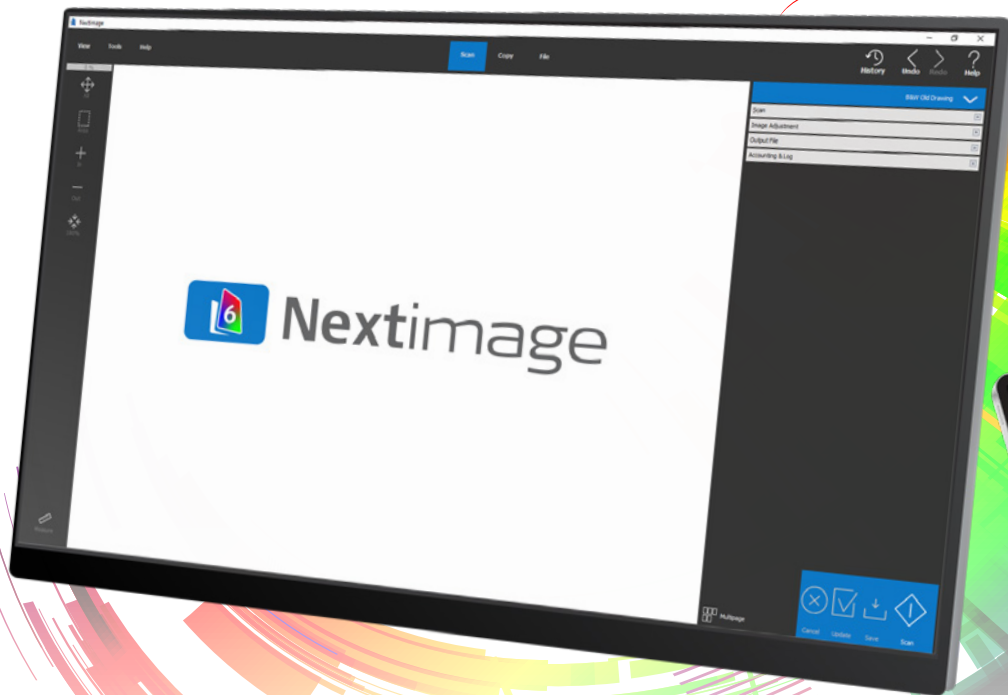

Nextimage

HD IQ SD

PROFESSIONAL
SOFTWARE



AWARD-WINNING SOFTWARE FOR LARGE FORMAT SCANNING

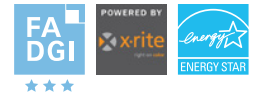

Nextimage Scan & Archive optimizes your scan and archive results.

Nextimage Repro includes batch scan and copy functions, closed loop calibration (CLC) and touchscreen compatibility.

More than just scanning

Nextimage brings out unseen details and restores even the faintest originals. Scan in vibrant color in sRGB, Adobe RGB or Device RGB. Capture and improve maps using advanced filters color reduction options. Digitize and restore monochrome originals with unique adaptive filters and advanced background suppression.

No file size limit

Utilizing the full 64-bit OS, Nextimage is able to capture the longest originals in the industry. No original is too big for this software because if limits are reached in TIF and PDF file formats Nextimage quickly switches to creating multiple images per page to ensure nothing is left unscanned.

Save time with Nextimage Remote app for Apple and Android tablets

Nextimage Remote app cleverly mimics the Nextimage program running on the PC. This app can vastly reduce the amount the operator needs to move between the scanner and the workstation.

ICC color profiles

The ICC color management in Nextimage 6 is powered by X-Rite®.

Exceeding FADGI 3-stars

The image quality from Nextimage 6 exceeds the FADGI 3-star standard when used with HD Ultra X, IQ Quattro X, IQ FLEX, SD One MF, ScanStation Pro and MFP Repro.

Batch scanning

No need to press 'scan' every single time you feed the scanner a new original.

Soft-handling

Use this option to have the scanner take extra special care when loading, accelerating and ejecting by slowing everything down a little bit.

Printer compatibility

No large format scanner software has a longer list of compatible printer drivers than Nextimage.

THE BEST YOU CAN DO FOR YOUR ORIGINALS

SEE MORE: contex.com/nextimage-software

 **contex**[®]
WHEN IMAGING MATTERS

NEXTIMAGE SOFTWARE SPECIFICATIONS	
Built-in wide format printers support	Canon, HP, Epson, Océ, MUTOH, others. See all printers: contex.com/nextimage-supported-printers
Contex recommends	Intel Core i5, AMD Ryzen 5 5500, or better 64-bit processors, 16 GB RAM and SSD SATA drive, min. USB 3.0 or Gigabit Ethernet
Operating systems	Windows 11 64-bit, Windows 10 64-bit, Windows Server 2022 Standard Edition
File formats	Multipage PDF & TIF, JPG, PDF, PDF/A, DWF, CALS, BMP, JPEG-2000(JP2), JPEG2000 Extended(JPX), TIF-G3, TIF-G4, and others
Supported languages	Chinese, Dutch, English, French, German, Italian, Japanese, Korean, Polish, Russian, Spanish

	SCAN & ARCHIVE	REPRO
	For powerful and user-friendly scanning and archiving	Includes direct copy functionality and touchscreen compatibility
Windows application	Standard	Standard or touchscreen mode
FULL SCAN FUNCTIONS		
ICC color management powered by X-Rite®	✓	✓
Multiple exposures (exceed FADGI 3-stars) ¹	✓	✓
Batch scanning	✓	✓
SnapScan: Scan – Enhance – Save	✓	✓
REimage ²	✓	✓
Automatic file naming templates	✓	✓
Customize/Edit index color palette	✓	✓
Accounting	✓	✓
FULL IMAGE ADJUSTMENT CONTROL		
Auto-rotate	✓	✓
Auto-align/deskew	✓	✓
Sharpen/Smoothen filter	✓	✓
Black/White level adjustment	✓	✓
RGB level adjustments	✓	✓
Histogram view	✓	✓
Measurement tool	✓	✓
TWAIN driver	✓	✓
FULL COPY FUNCTIONS		
Direct copy		✓
Batch copy		✓
Closed loop color calibration		✓

- Scan with multiple exposures per scan line with the 'Quality' option to significantly reduce image noise and ensure more accurate colors. Applicable for: HD Ultra X, IQ Quattro X, IQ FLEX, SD One MF, ScanStation Pro, MFP Repro
- Reopen scanned images with the RAW image information still intact and adjustable

Nextimage software supports all Contex scanners and delivers a complete set of tools to ensure image quality for all tasks.

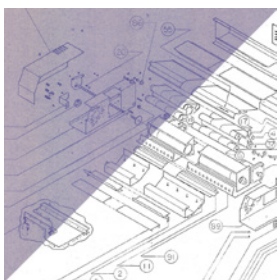

Adaptive threshold algorithm
Nextimage comes with an advanced B&W algorithm that combines background cleaning and preservation of grayscales in one mode. Use it for both clean new originals and for low contrast blueprints.



Smoothen/sharpen filters
The smart Smoothen filter intelligently removes pattern noise without blurring the edges in the original. Combine it with the Sharpen algorithm to get razor sharp results with smooth noiseless colors.

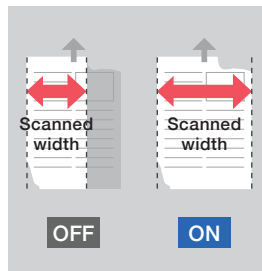

Full length auto size
Nextimage full length auto size ensures all available information is scanned even if more than one edge is incomplete.

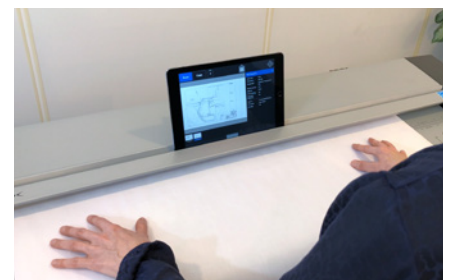

Workflow optimized
Remote control and operate Nextimage software from your tablet with Nextimage Remote.

The Nextimage Remote app for iOS and Android tablets allows the Nextimage software to be operated right on top of the scanner for maximum convenience and user comfort.

Contex solutions are compatible with all leading large-format printers. See the full list at contex.com/nextimage-supported-printers



National / AZON
1148 Rochester Rd., Troy, MI 48083
Phone: 800-260-0839, azon.com, info@azon.com