

The front office wide format scanner fi-7460 Document Scanner

Designed for heavy workloads and engineered to last, the fi-7460 scanner offers wide-format scanning in a compact, best-in-class space. Robust feeding of mixed documents and automatic stacking technology reduces document handling time and total cost of scanning.



Image Quality

This wide-format scanner is built with powerful charge-coupled device (CCD) cameras to capture large, double-letter and odd sized papers with clarity and color precision. These dual CCDs capture both sides of a document with accurate focus and color reproduction while maintaining rated speeds.

Paper Feeding

Engineered for superior paper feeding, the fi-7460 can easily handle thick, thin, wide, and narrow documents. The 100 page feeder feeds in stacks of pages rapidly. With smart skew resistance, a built-in manual feed mode switch, and automatic stacking technologies, feeding and retrieval is simple and efficient.

Reliability

The fi-7460 is built to last and powers up every time you need it, regardless of job size. Strong urethane rollers, heavy duty motors, a sturdy frame, and durable consumables combine for a long-lasting scanner that will let your organization capture the volumes of paper from seasonal peaks and heavy backlogs worry free. Backed by US-based, legendary solutions architects and support teams.



PaperStream IP

Compatible with all major document management software packages, PaperStream IP (PSIP) is a TWAIN/ISIS® compliant driver that cleans up and optimizes scanned images without any configuration.

PaperStream Capture

Take advantage of powerful indexing and sorting features, putting the document in the right location for great organization and fast retrieval. Now includes both 2D and 1D barcode support in the box.

PaperStream Clickscan

Easy-to-use capture software for any business. Simple scanning interface with 3-steps: scan, select destination, and save.

Scanner Central Admin

Increase IT efficiency by using our free software to monitor, update, and deploy a fleet of scanners.

The front-office wide format scanner

fi-7460 Document Scanner

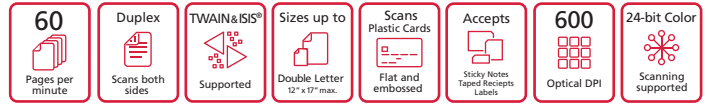

Technical Information

Scanner Type	ADF (Automatic Document Feeder) / Manual Feed, Duplex	Power Consumption	Operating Mode: 36 W or less Sleep Mode: 1.4 W or less (LAN) / 1.4 W or less (USB) Auto Standby (Off) Mode: 0.3 W or less
Scanning Speed^{*1} (A4 Landscape) (Color / Grayscale ^{*2} / Monochrome ^{*3})	Simplex: 60 ppm (200/300 dpi) Duplex: 120 ipm (200/300 dpi)	Operating Environment	Temperature: 41 to 95°F (5 to 35°C) Relative Humidity: 20 to 80% (non-condensing)
Image Sensor Type	CCD x 2 (front x 1, back x 1)	Environmental Compliance	ENERGY STAR®, RoHS
Light Source	White LED Array x 4 (front x 2, back x 2)	Dimensions^{*15} (Width x Depth x Height)	15.0 x 8.2 x 6.6 in. (380 x 209 x 168 mm)
Optical Resolution	600 dpi	Weight	16.72 lbs (7.6 kg)
Output Resolution^{*4} (Color / Grayscale / Monochrome)	50 to 600 dpi (adjustable by 1 dpi increments) 1,200 dpi (driver) ^{*5}	Supported Operating System	Windows® 11, Windows® 10, Windows® Server 2022, Windows® Server 2019, Windows® Server 2016, Linux (Ubuntu)
Output Format	Color: 24-bit, Grayscale: 8-bit, Monochrome: 1-bit	Included Software / Drivers	PaperStream IP Driver (TWAIN/TWAIN x64/ISIS), WIA Driver ^{*15} , Image Scanner Driver for Linux (SANE) ^{*15} ^{*16} PaperStream Capture, PaperStream ClickScan ^{*16} , Software Operation Panel, Error Recovery Guide, ABBYY FineReader for ScanSnap™ ^{*16} , Scanner Central Admin
Background Colors	White/Black (selectable)	Image Processing Functions	Multi image output, Automatic color detection, Blank page detection, Dynamic threshold (iDTC), Advanced DTC, SDTC, Error diffusion, Dither, De-Screen, Emphasis, Dropout color (None/Red/Green/Blue/White/Saturation/Custom), sRGB output, Hole punch removal, Index tab cropping, Split image, De-Skew, Edge correction, Vertical streaks reduction, Cropping, Static threshold
Document Size	12 in. x 17 in. (304.8 x 431.8 mm) Maximum ^{*6} Minimum Long Page Scanning ^{*7}	Included Items	ADF paper chute, AC cable, AC adapter, USB cable, Setup DVD-ROM
Paper Weight (Thickness)	7.2 to 110 lb (27 to 413 g/m ²) ^{*8} Paper Plastic Card	Standard Model	PN: PA03710-B055 (trade compliant) ^{*17}
ADF Capacity^{*10} ^{*11}	100 sheets (Letter 20 lb or A4 80 g/m ²) 50 sheets (Double Letter 20 lb)	Certifications	Tungsten® VRS Elite
Expected Daily Volume^{*12}	18,000 sheets	Warranty	3 Months Basic Onsite Service
Multifeed Detection	Overlap detection (Ultrasonic sensor) Length detection		
Paper Protection	Lag detection, Sound detection (iSOP) ^{*13}		
Interface	USB		
Power Requirements	AC 100 to 240 V 50/60Hz		

Service Programs & Options

ScanCare	S7460-SCMYNBD-3	3-year scanner contract with parts, consumables, labor, training, 1 cleaning visit per year, and next business day response time	Industry-leading support keeps digital transformation projects on-time and on budget
	S7460-SCPWNBD-1	1-year scanner contract with parts, consumables, labor, training, 1 cleaning visit per year, and next business day response time	
Basic	S7460-BAMYNBD-3	3-year scanner contract with parts, labor, 1 cleaning visit per year, and next business day response time	<ul style="list-style-type: none"> • U.S. based support • Specialized Teams • Flexible service programs
	S7460-BAPWNBD-1	1-year scanner contract with parts, labor, 1 cleaning visit per year, and next business day response time	
Advance Exchange	S7460-AEMYNBD-3 S7460-AEPWNBD-1	3-year scanner contract shipping a replacement unit shipped overnight* 1-year scanner contract shipping a replacement unit shipped overnight*	
PaperStream Capture Pro	PSCP-DP-0001	PaperStream Capture Pro Departmental software license	

Consumables and Options

Imprinter (Post)	PA03710-D401	User installable. Prints a string of characters on the back of document after scan
Print Cartridge	CA00050-0262	Lifetime: approx. 4,000,000 printed characters
Brake Roller	PA03710-0001	Lifetime: approx. 200,000 sheets or 1 year
Pick Roller	PA03670-0002	Lifetime: approx. 200,000 sheets or 1 year
ScanAid Kit	CG01000-288201	Consumable kit with instructions and cleaning supplies



^{*1} Actual scanning speeds may vary with data transmission and software processing times. ^{*2} Indicated speeds are from using JPEG compression. ^{*3} Indicated speeds are from using TIFF CCITT Group 4 compression. ^{*4} Selectable maximum resolution may vary depending on the length of the scanned document. ^{*5} Limitations may apply to the size of documents that can be scanned, depending on system environment, when scanning at high resolution (over 600 dpi). ^{*6} Maximum document width possible for scanning is 9.5 in. (240 mm). ^{*7} 200dpi or less : 220 inch, 300dpi or less : 215inch, 400dpi or less : 160inch, 600dpi or less : 106.3inch ^{*8} Thicknesses of up to 34 to 56 lb (128 to 209 g/m²) can be scanned for A8 (2.1 x 2.9 in. / 52 x 74 mm) sizes. ^{*9} Continuous feeding is supported when scanning up to 10 unembossed cards with thicknesses of 0.76 mm or less. ^{*10} Maximum capacity depends on paper weight and may vary. ^{*11} Capable of setting additional documents while scanning. ^{*12} Numbers are calculated using scanning speeds and typical hours of scanner use, and are not meant to guarantee daily volume or unit durability. ^{*13} Intelligent Sonic Paper Protection. ^{*14} Excludes the ADF paper chute and stacker. ^{*15} Functions equivalent to those offered by PaperStream IP may not be available with the Image Scanner Driver for macOS/Linux or WIA Driver. ^{*16} Refer to the fi Series Support Site for driver/software downloads and full lineup of all supported operating system versions. www.pfu-us.ricoh.com. ^{*17} EPEAT is Silver.

*Replacement units shipped overnight for all requests received by 2 P.M. PST, Monday-Friday

Trademarks

ISIS is a trademark of OpenText. Microsoft, Windows, and Windows Server are either registered trademarks or trademarks of Microsoft Corporation in the United States and/or other countries. macOS is a trademark of Apple Inc., registered in the U.S. and other countries. Linux is the registered trademark of Linus Torvalds in the U.S. and other countries. Any other products or company names appearing in this document are the trademarks or registered trademarks of the respective companies.

Safety Precautions

Please carefully read the safety precautions prior to the use of this device and follow the recommended instructions for correct use. Do not place this device in wet, moist, highly humid, dusty or oily areas. Use of this device under such conditions may result in electrical shock, fire or damage to the device. Please use this device within the power ratings listed.

ENERGY STAR®

PFU Limited, a Ricoh company, has determined that this product meets the ENERGY STAR® guidelines for energy efficiency. ENERGY STAR® is a registered trademark of the United States. Specifications are subject to change without notice.